

S/390



Parts Catalog

Multiprise® 3000 Enterprise Server

S/390



Parts Catalog

Note!

Before using this information and the product it supports, read the information under Appendix B, "Notices" on page 39.

Second Edition (June, 2000)

This edition applies to the S/390 Multiprise 3000 Enterprise Server.

© **Copyright International Business Machines Corporation 1999, 2000. All rights reserved.**

Note to U.S. Government Users — Documentation related to restricted rights — Use, duplication or disclosure is subject to restrictions set forth in GSA ADP Schedule Contract with IBM Corp.

Contents

Preface	v
Using This Guide	v
Who Should Use This Guide	v
Catalog Section	3
Assembly 1: Frame Assembly	4
Assembly 2: Frame Assembly	6
Assembly 3: Frame Assembly	8
Assembly 4: Frame Assembly	10
Assembly 5: Frame Assembly	12
Assembly 6: Frame Assembly	14
Assembly 7: Frame Assembly with Doors	16
Assembly 8: Covers and Frame	18
Assembly 9: Cage Assembly	20
Assembly 10: I/O Assembly	22
Assembly 11: DASD	24
Assembly 12: PCI Cage Assembly	26
Assembly 13: Power Assemblies	28
Assembly 14: Cables	30
Part Number Index	33
Appendix A. Warranty	35
Statement of Limited Warranty	35
Appendix B. Notices	39
Trademarks	39
Electronic Emission Notices	40

Preface

Using This Guide

This Parts Catalog contains listings and illustrations of replaceable assemblies and detailed parts.

Who Should Use This Guide

IBM has prepared this manual for the use of IBM customer service representatives in the installation, maintenance, and repair of the specific machines indicated. IBM makes no representations that it is suitable for any other purpose.

Use the following procedure to determine the part numbers of the FRUs within a CPC or expansion box.

1

Ensure you are logged on the support element in service mode.

On the Support Element Workplace window:

1. Open **Task List** from **Views**.
2. Open **CPC Configuration Tasks** from the **Task List Work** area.
3. Open **Groups** from **Views**.
4. Drag the **CPC** icon (using the right-hand mouse button) and drop it on **View Hardware Configuration** under **CPC Configuration Tasks**.

2

On the View Hardware Configuration window:

1. Select the part location from the menu.
2. Select **Details**.

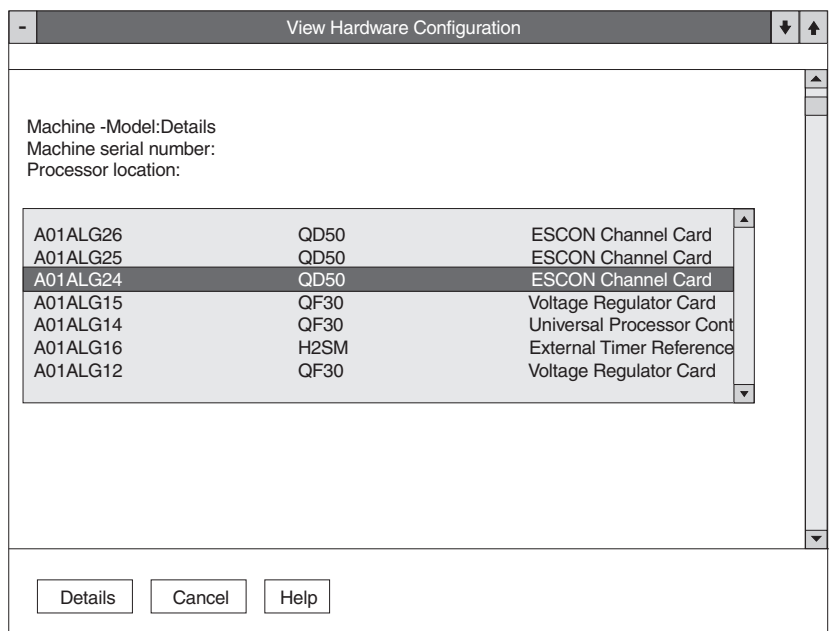

3

The Part Details windows shows information about the selected part.

When complete, select **OK**.

End of procedure.

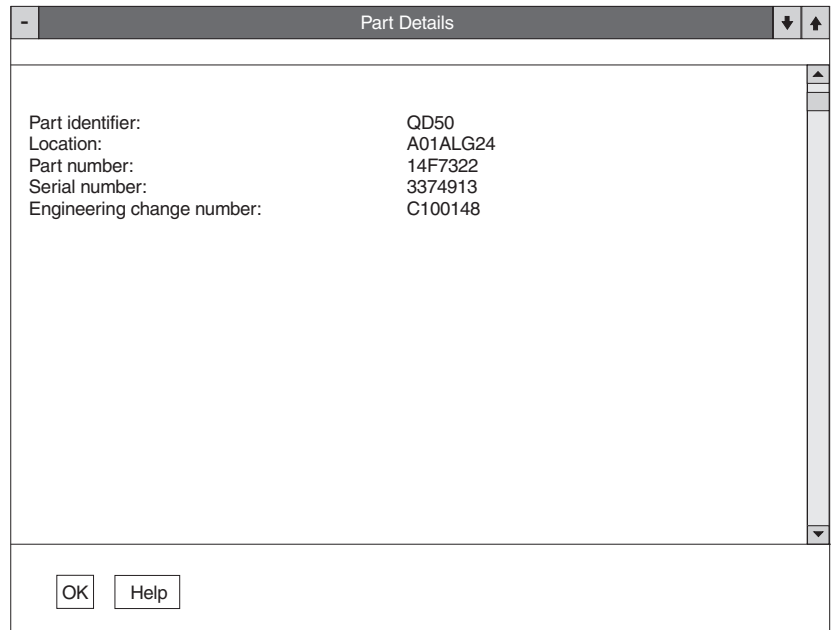

The screenshot shows a dialog box titled "Part Details". The dialog box has a title bar with a minus sign, the text "Part Details", and a close button (X). The main area of the dialog box contains the following text:

Part identifier:	QD50
Location:	A01ALG24
Part number:	14F7322
Serial number:	3374913
Engineering change number:	C100148

At the bottom of the dialog box, there are two buttons: "OK" and "Help".

Catalog Section

Assembly 1: Frame Assembly

Rear and side view

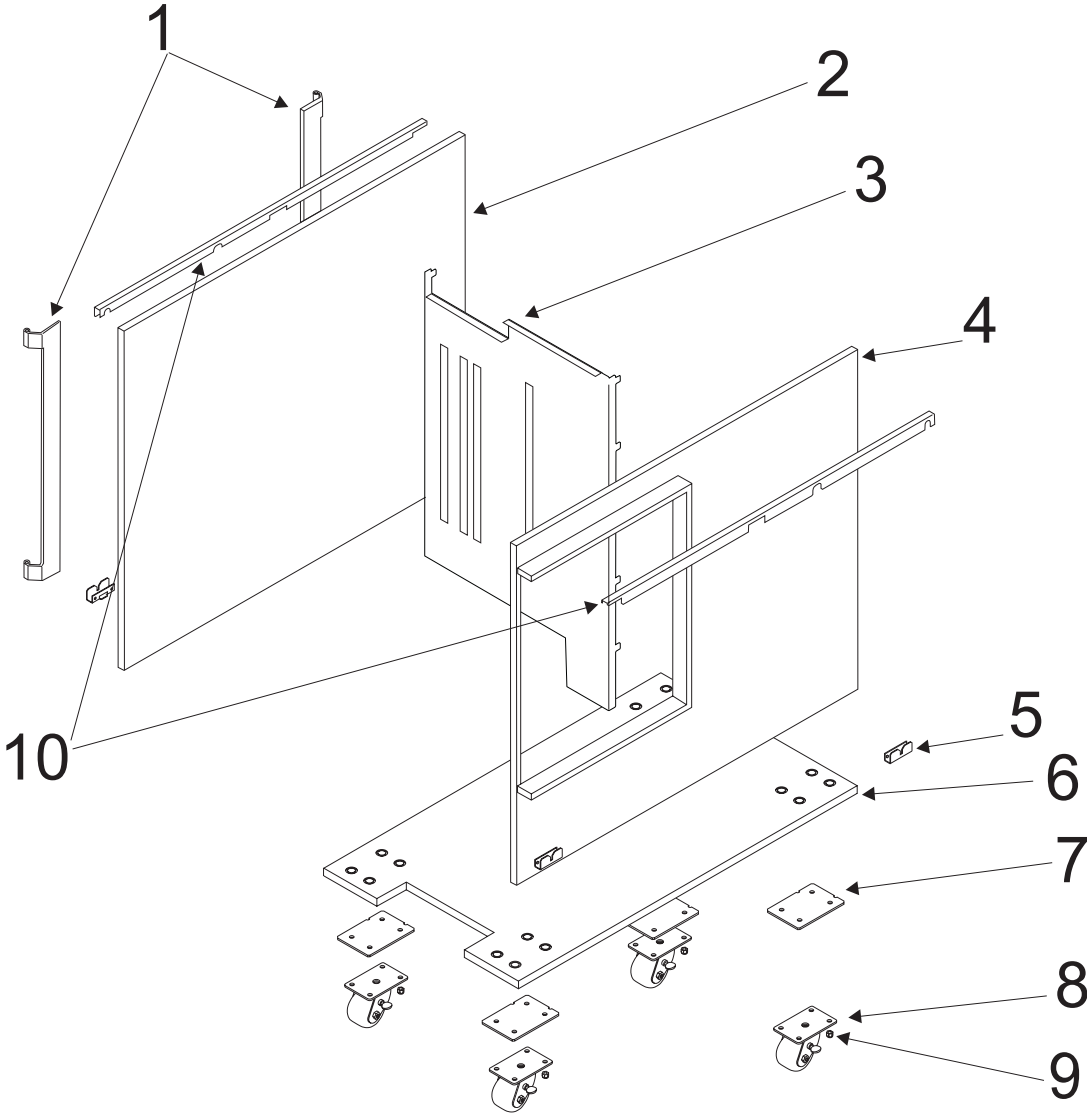

Asm- Index	Part Number	Units	Description
1-1	21L3833	2	Hinge Use 21F9002, (18) screws
-2	21L3366	1	Plate, Right Side Use 54G2882, (7) screws
-3	31L7094	1	Plate, Stiffener Use 21F9002, (12) screws
-4	31L7636	1	Plate, Left Side Use 54G2882, (7) screws
-5	21L3832	4	Bracket, Cover, Lower Mounting Use 21F9002, (8) screws
-6	05N6849	1	Base, Enclosure
-7	31L7644	4	Plate, Caster
-8	46G3536	4	Caster, Swivel
-9	1622419	16	Nut, M6 Elastic Stop
-10	21L3831	2	Bracket, Cover, Upper Mounting Use 21F9002, (12) screws

| **Assembly 2: Frame Assembly**

| Rear and side view

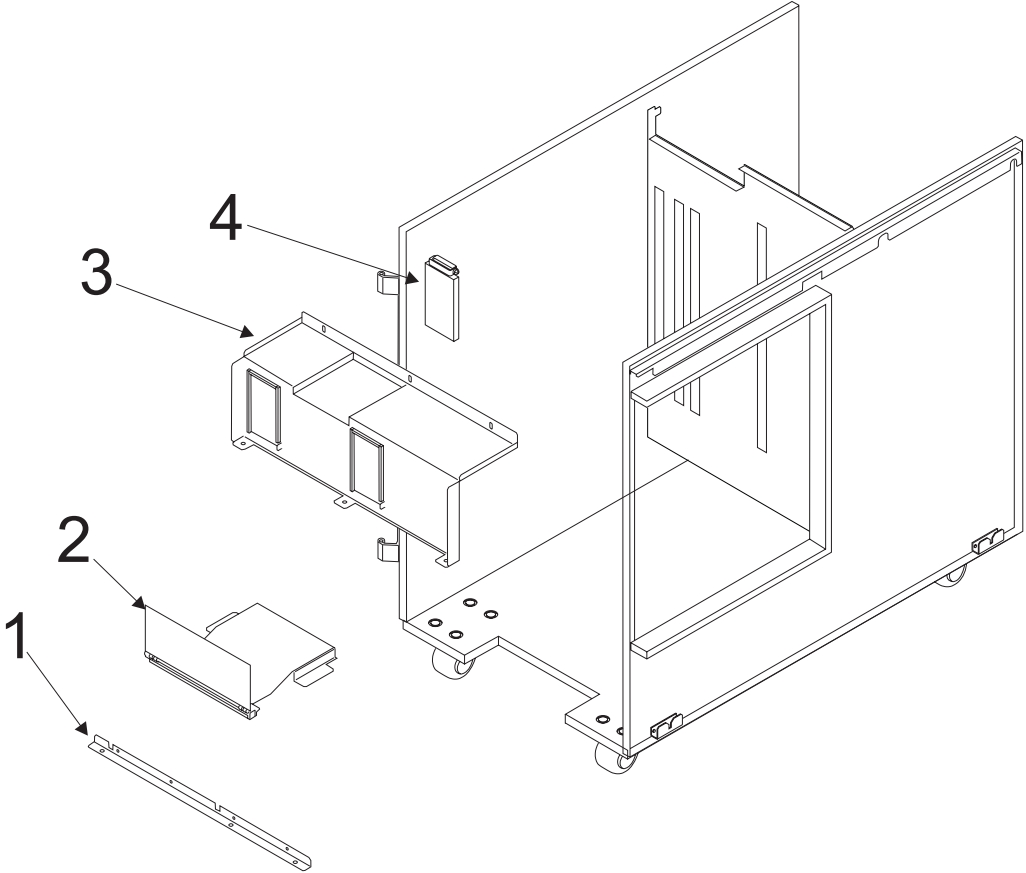

Asm- Index	Part Number	Units	Description
2-1	21L3345	1	Bracket, Panel Mounting Use 21F9002, (4) screws
-2	31L7420	2	Lower Service Door Assembly Use 1624775, (8) screws
-3	31L7694	1	Bracket, Exhaust Plenum Use 21F9002, (2) screws Use 1624775, (6) screws
-4	31L7098	2	Exhaust Flap Assembly Use 21F9002, (4) screws

| **Assembly 3: Frame Assembly**

| Rear and side view

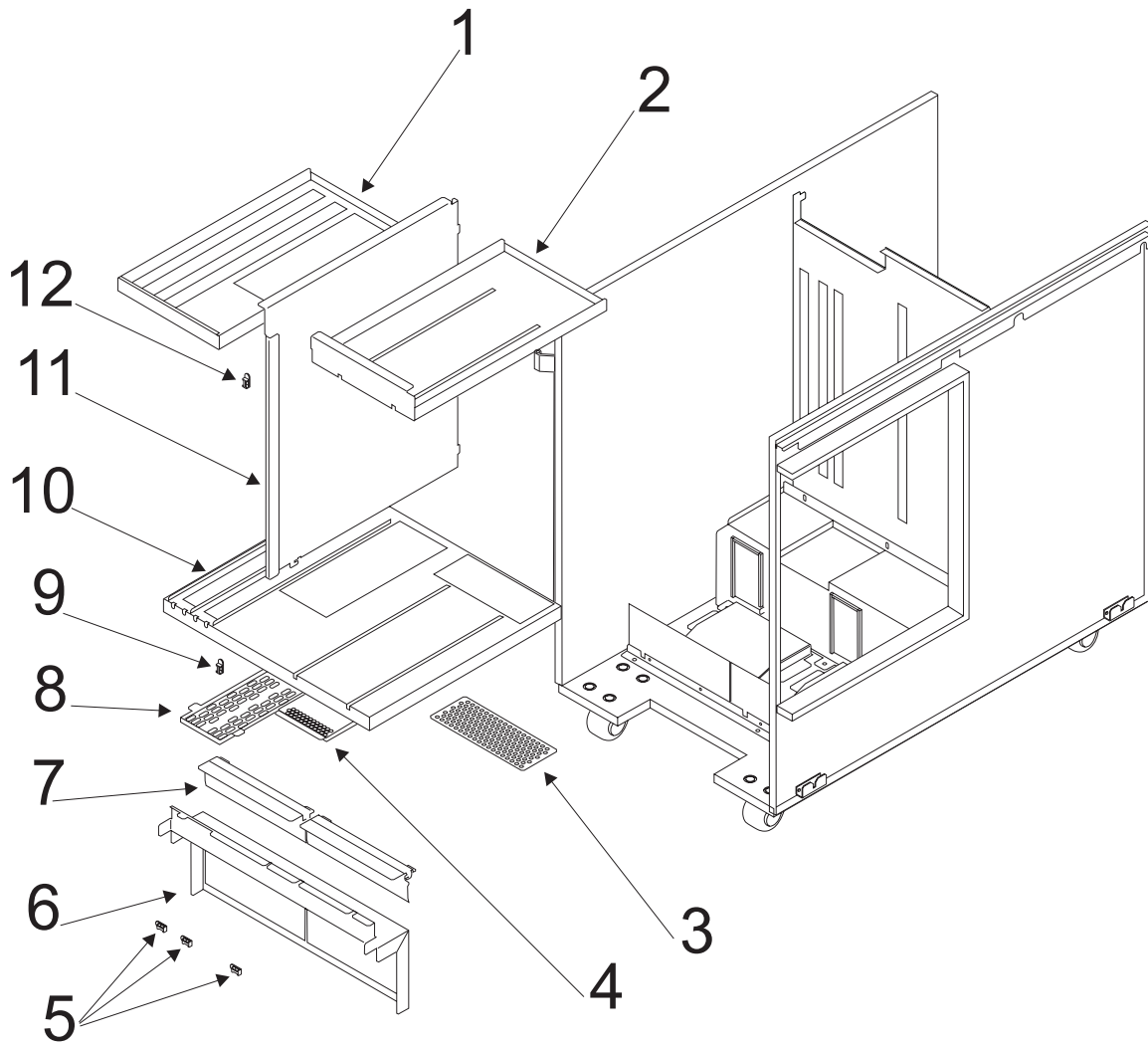

Asm- Index	Part Number	Units	Description
3-1	21L3352	1	Bracket, Upper Book Guide Use 1624775, (6) screws
-2	31L7633	1	Bracket, Upper PCI Guide Use 1624775, (6) screws
-3	31L7453	1	Plate, PCI Perforated Use 21F9002, (2) screws
-4	21L3791	1	Plate, PMI Perforated Use 21F9002, (4) screws
-5	84X5038	3	Tie Base Use 1624764, (3) screws
-6	31L7635	1	Bracket, Blower Mounting Use 21F9002, (10) screws
-7	31L7430	2	Upper Service Door Assembly Use 21F9002, (4) screws
-8	21L3792	1	Plate, OCA Perforated Use 21F9002, (4) screws
-9	84X5038	1	Tie Base Use 1624764, (1) screw
-10	31L7634	1	Bracket, Lower Guide Use 1624775, (8) screws Use 21F9002, (5) screws
-11	31L7695	1	Bracket, Rail Divider Use 21F9002, (2) screws
-12	84X5038	1	Tie Base Use 1624764, (1) screw

| **Assembly 4: Frame Assembly**

| Rear and side view

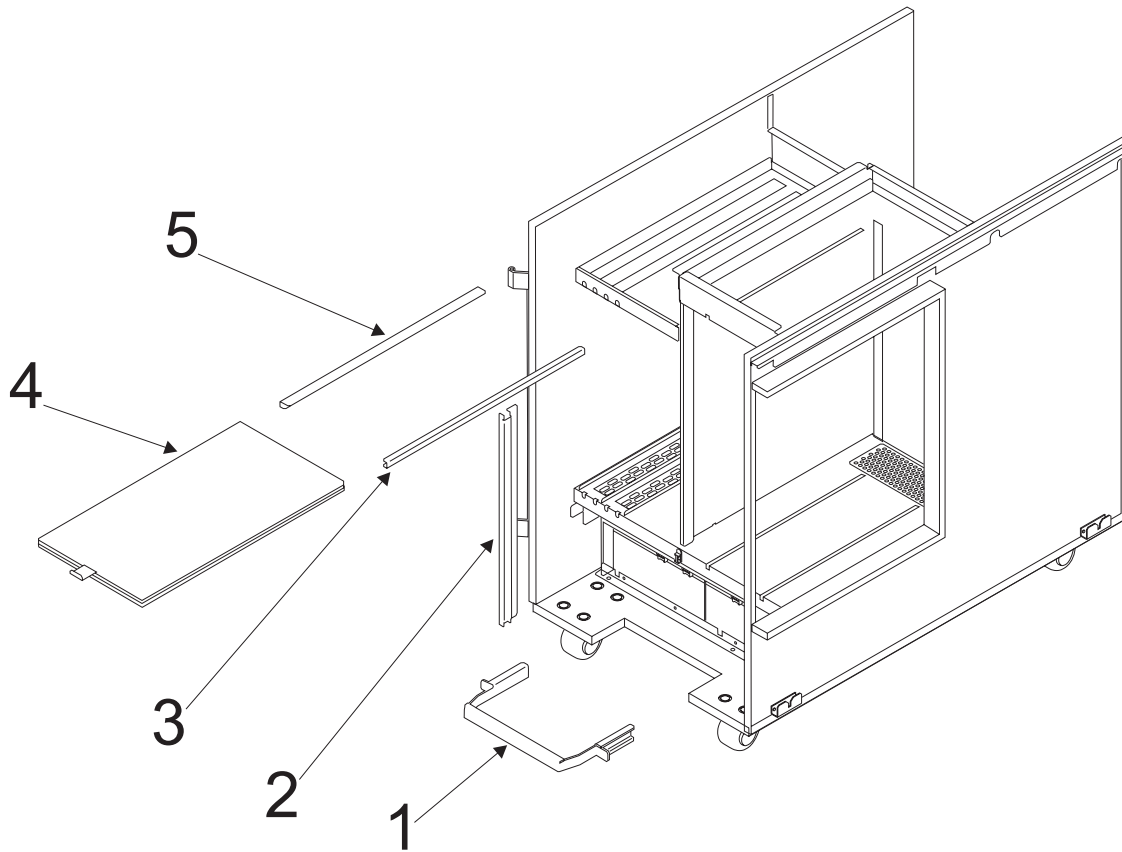

Asm- Index	Part Number	Units	Description
4-1	21L3837	1	Bracket, Cable Retainer Use 1624775, (2) screws
-2	21L3354	1	Bracket, Pitch Filler Use 1624775, (2) screws
-3	21L3789	1	Bracket, Right Filter Use 21F9002, (2) screws
-4	21L3787	1	Air Filter
-5	21L3788	1	Bracket, Left Filter Use 21F9002, (2) screws

| **Assembly 5: Frame Assembly**

| Front and side view

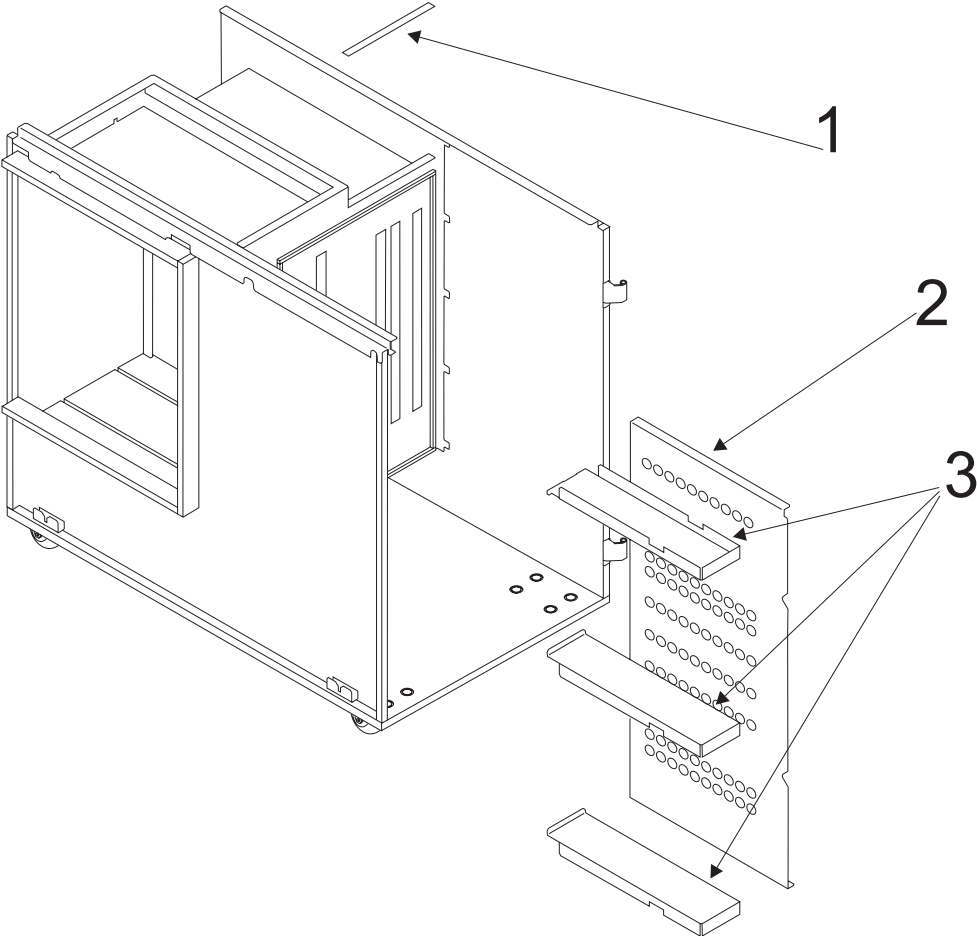

Asm- Index	Part Number	Units	Description
5-1	21L3804	1	Foam, Cable Tray
-2	31L7034	1	Plate, Battery Wall Use 1624775, (7) screws
-3	21L3510	3	Bracket, IBF Use 1624775, (12) screws

| **Assembly 6: Frame Assembly**

| Rear and side view

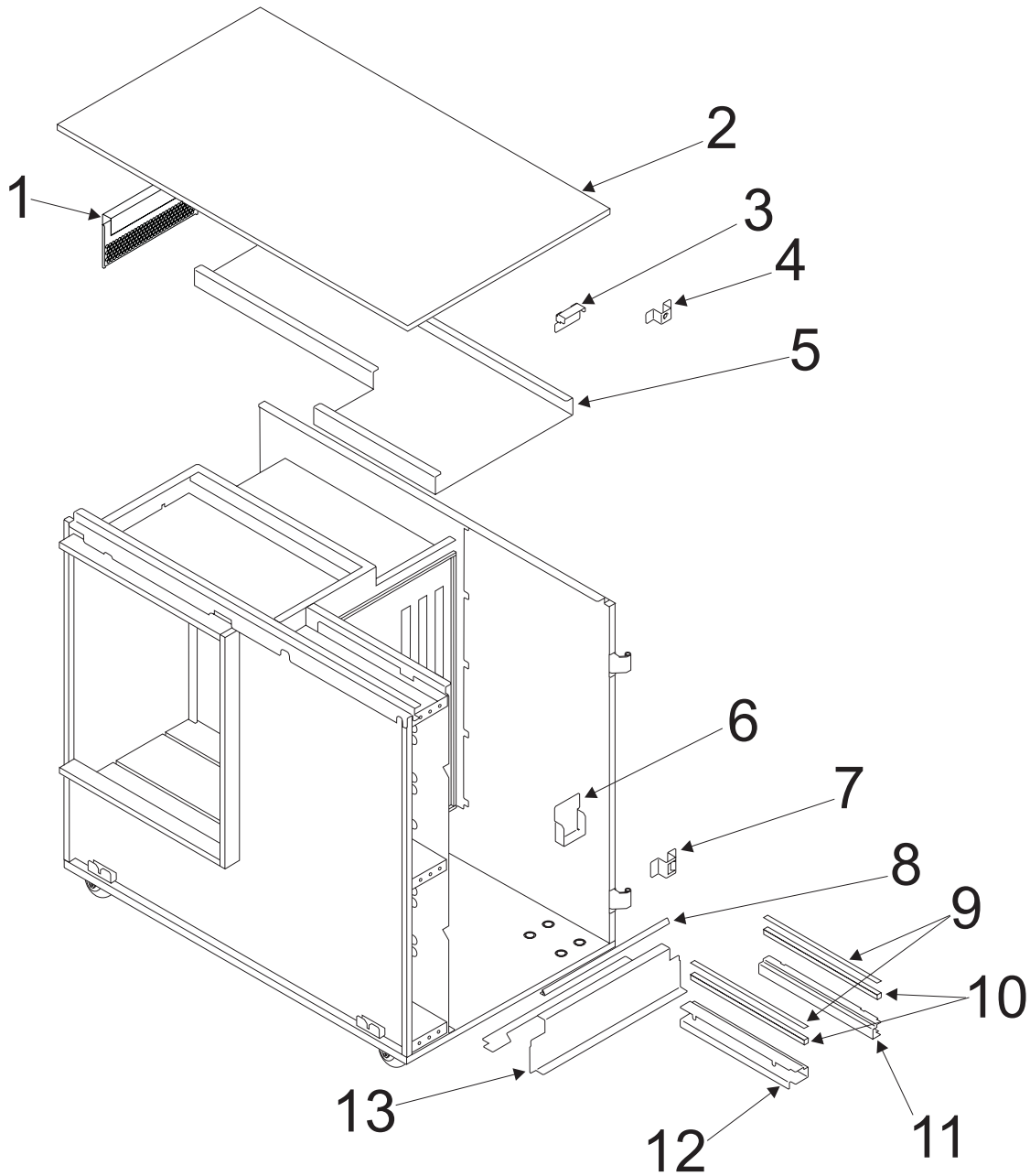

Asm- Index	Part Number	Units	Description
6-1	21L3853	1	Plate, Inlet Perforated Use 1624775, (2) screws
-2	31L7024	1	Plate, Enclosure Top Use 21F9002, (23) screws
-3	45L3588	1	Upper Guide Bracket Use 21F9002, (3) screws
-4	45L3592	1	Bracket Upper Pin Locator Use 1624742, (2) screws
-5	21L3802	1	Cable Tray Use 21F9002, (11) screws
-6	45L3589	1	Lower Guide Bracket Use 21F9002, (3) screws
-7	45L3593	1	Lower Pin Locator Use 1624742, (2) screws
-8	21L3374	1	Gasket, EMC
-9	31L7417	2	Film, Plenum
-10	31L7416	2	Foam, Plenum
-11	31L7415	1	Bracket, Right Cage Support Use 21F9002, (2) screws
-12	31L7414	1	Bracket, Left Cage Support Use 21F9002, (2) screws
-13	21L3372	1	Plate, Air deflector Use 21F9002, (6) screws

| **Assembly 7: Frame Assembly with Doors**

| Front and side view

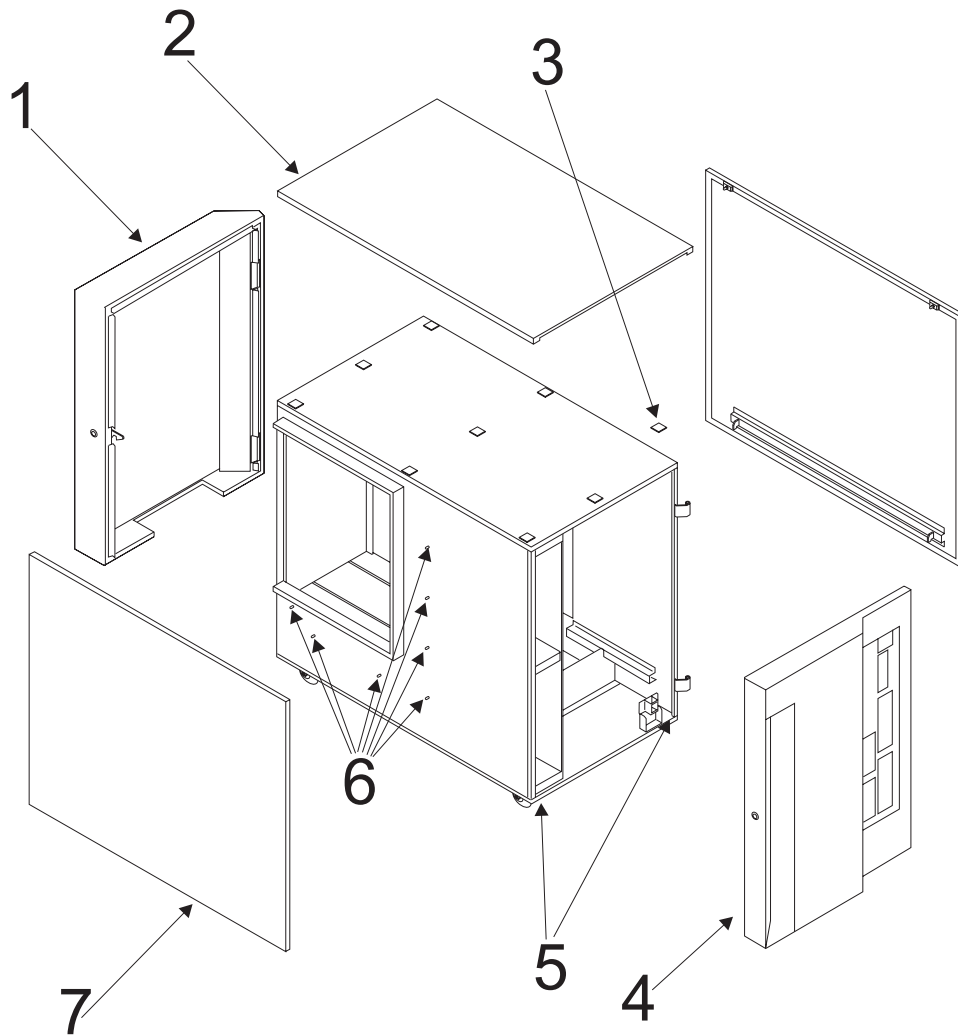

Asm- Index	Part Number	Units	Description
7-1	21L3840	1	Rear Door
-2	21L3828	1	Cover, Top
			Use 21F9002, (4) screws
-3	21L3830	9	Pad
-4	45L3587	1	Front Door
-5	19F0740	1	Gasket
			Cut two (2) pieces 831.7 mm long
-6	31L7648	8	Cap
-7	12K0277	2	Cover, Side

Assembly 8: Covers and Frame

Assembly view, front and side

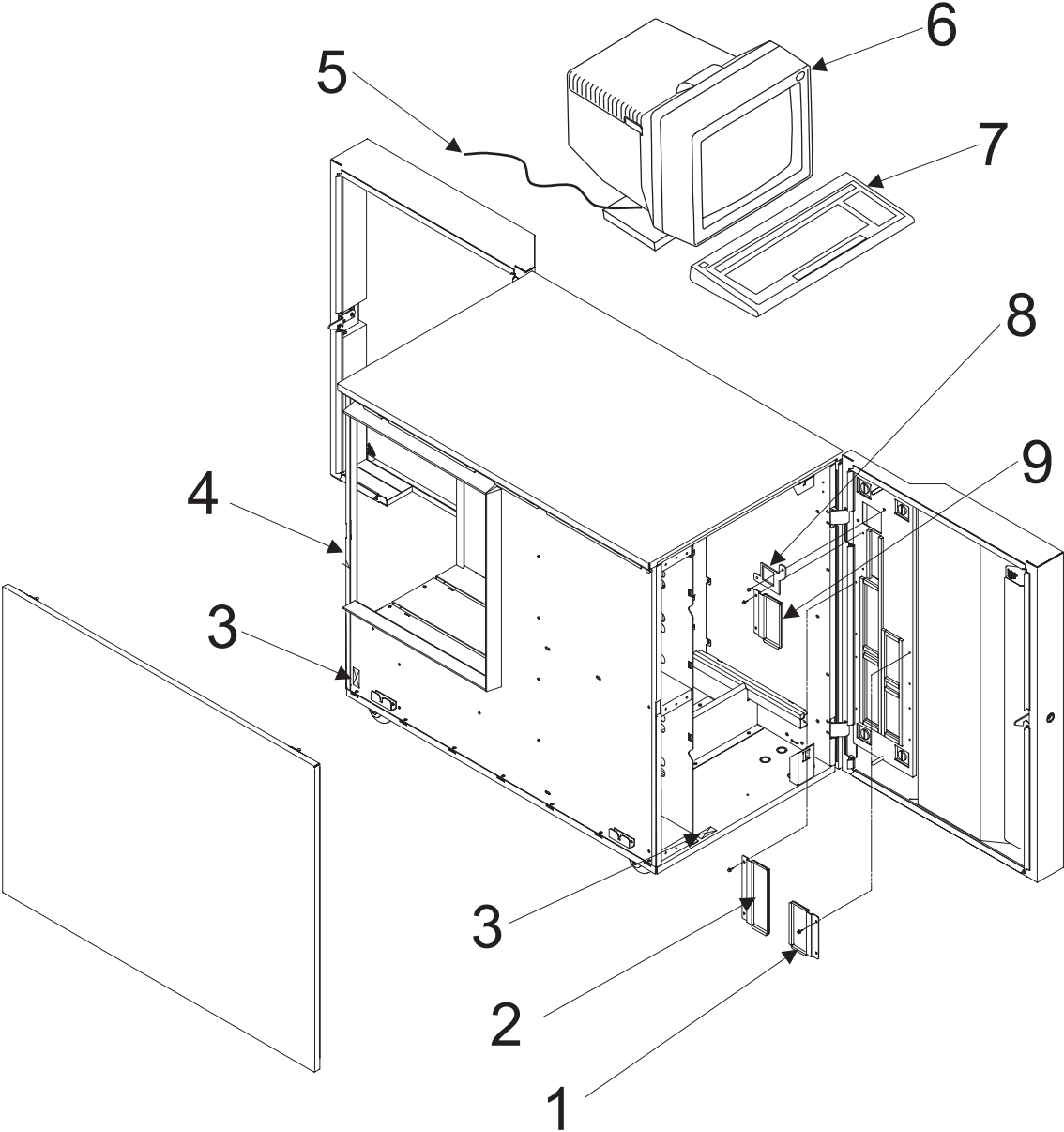

Asm- Index	Part Number	Units	Description
8-1	45L3598	AR	DAT Decorative Cover Plate Use 1624764, (2) screws
-2	45L3599	AR	CDROM Decorative Cover Plate Use 1624764, (2) screws
-3	42G4996	AR	Label Blank
-4	31L7972	1	Frame Assembly, Base (Processor)
-4	31L7974	1	Frame Assembly, DASD Expansion
-4	31L7976	1	Frame Assembly, I/O Expansion
-5	31L7062	1	Line Cord, Monitor, US/Canada
-5	13F9979	1	Line Cord, Monitor, France, Germany Spain, Portugal, Brazil, Norway, Sweden, Finland, Netherlands, Belgium, Denmark
-5	14F0069	1	Line Cord, Monitor, Italy
-5	38F3968	1	Line Cord, Monitor, French Canada, UK
-5	6952301	1	Line Cord, Monitor, French Canada, UK
-5	14F0051	1	Line Cord, Monitor, Switzerland
-6	60H9963	1	Monitor, 19 inch (17.9 inch viewable)
-6	60H9965	1	Monitor, 19 inch (17.9 inch viewable)
-6	60H9967	1	Monitor, 21 inch (19.8 inch viewable)
-6	60H9969	1	Monitor, 21 inch (19.8 inch viewable)
-7	07H0665	1	Keyboard Assembly, US
-7	07H0680	1	Keyboard Assembly, French
-7	07H0681	1	Keyboard Assembly, German
-7	07H0669	1	Keyboard Assembly, Spanish (Not Spain)
-7	07H0696	1	Keyboard Assembly, Spanish
-7	07H0687	1	Keyboard Assembly, Italian
-7	42H1295	1	Keyboard Assembly, Canadian French
-7	07H0690	1	Keyboard Assembly, Portuguese
-7	07H0671	1	Keyboard Assembly, Brazilian Portuguese
-7	07H0701	1	Keyboard Assembly, UK English
-7	07H0688	1	Keyboard Assembly, Norwegian
-7	07H0697	1	Keyboard Assembly, Swedish/Finnish
-7	07H0679	1	Keyboard Assembly, Dutch
-7	07H0675	1	Keyboard Assembly, Belgian French
-7	07H0678	1	Keyboard Assembly, Danish
-7	07H0698	1	Keyboard Assembly, Swiss French, German
-8	31L7690	1	Bezel Assembly Use 1621190, (2) screws
-9	45L3600	1	Floppy Disk Decorative Cover Plate Use 1624764, (2) screws

Assembly 9: Cage Assembly

Cage Assembly, front and side

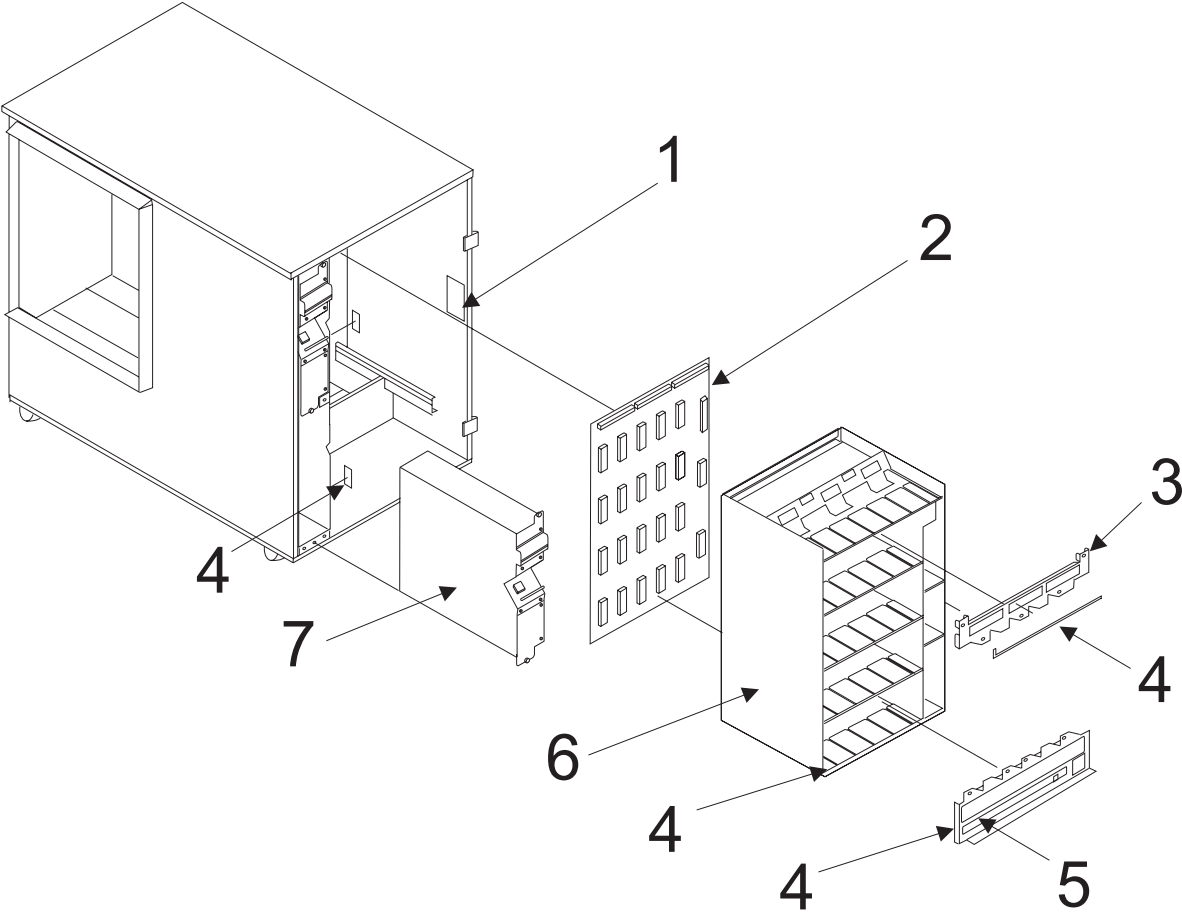

Asm- Index	Part Number	Units	Description
9-1	31L7632	1	Hazardous Energy Label
-2	60H1108	1	Midplane Board Assembly Use 4236316, (4) screws Use 1622347, (4) lock washers
-3	31L7638	1	Plate Use 1624764, (5) screws
-4	31L7463	AR	Label Set, Ref
-5	21L3369	1	Plate Use 1624764, (7) screws
-6	31L7640	1	Cage Assembly Use 5462882, (12) screws
-7	44H2792	2	Battery

Assembly 10: I/O Assembly

Assembly view, front and side

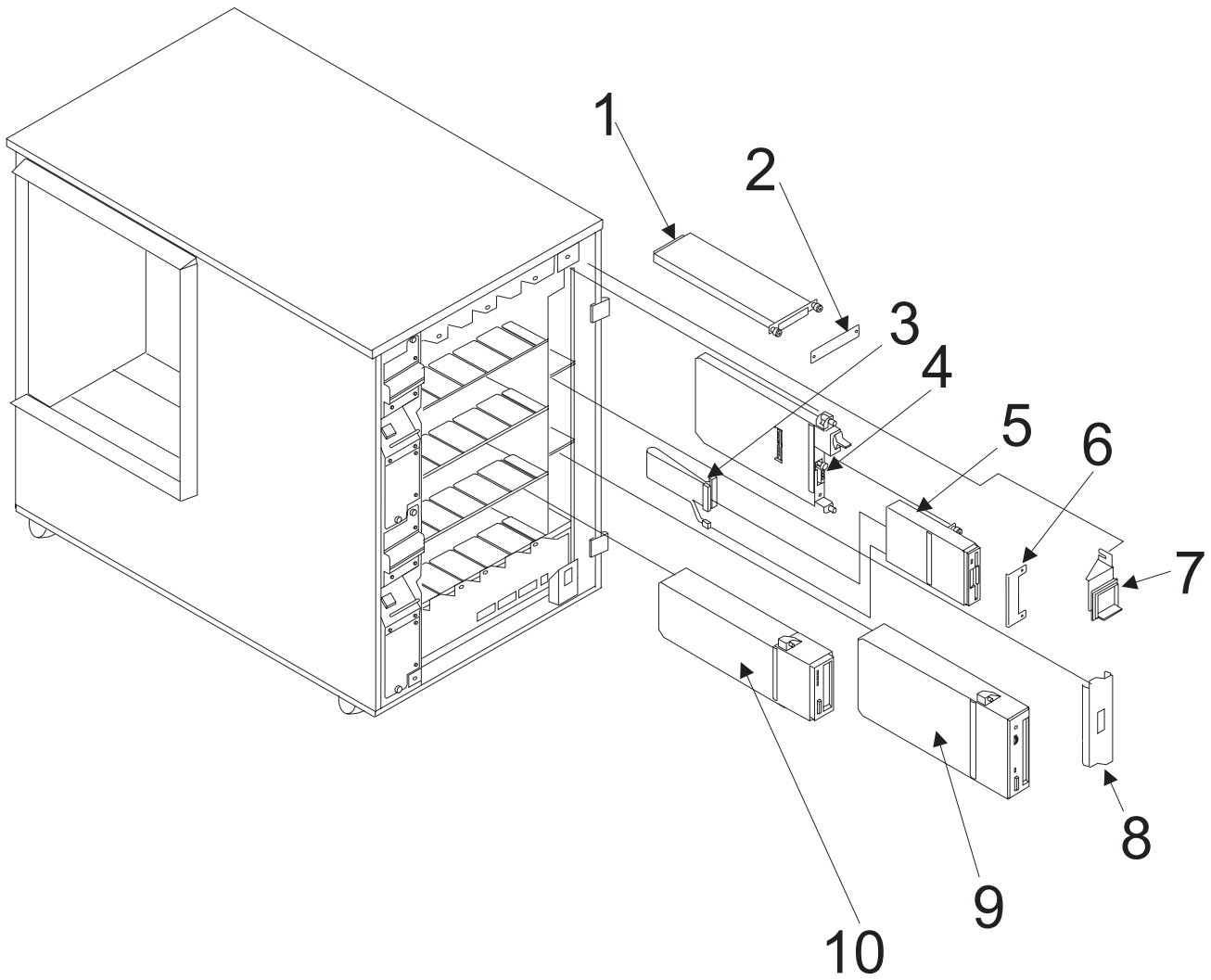

Asm- Index	Part Number	Units	Description
10-1	05N5370	1	SSA Extender Card
-2	47H0216	1	Extender Dummy Cover Use 1624764, (2) screws
-3	21L3816	1	Cable
-4	12K0294	1	EPO Card
-5	31L7643	1	Floppy Drive Assembly
-6	31L8002	1	Floppy Drive Dummy Cover Use 1624764, (2) screws
-7	31L7625	1	Switch Bezel Assembly Use 1624764, (2) screws
-8	21L3515	1	CDROM Dummy Cover Use 1624764, (2) screws
-9	11P0586	1	CDROM Assembly
-10	05N6839	1	DAT Assembly

Assembly 11: DASD

Assembly view, rear and side

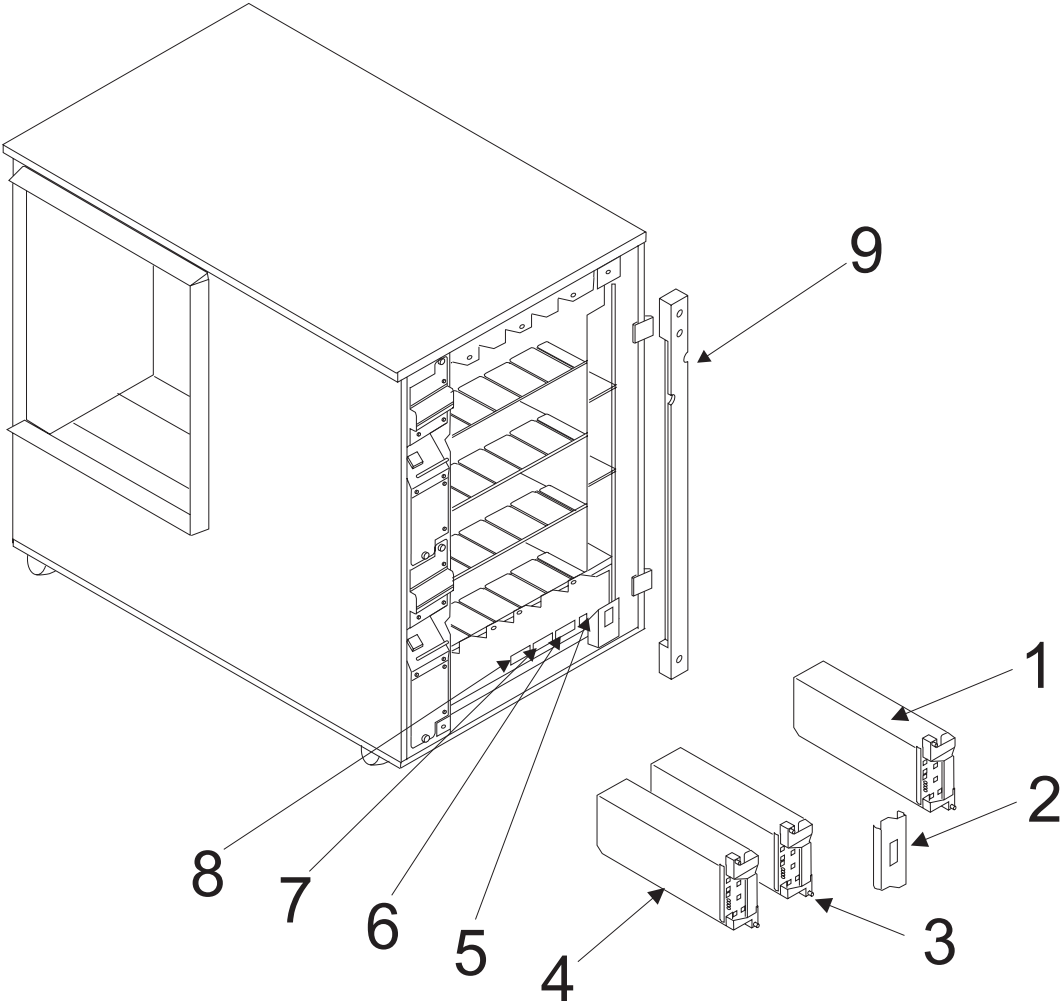

Asm- Index	Part Number	Units	Description
11-1	12K0473	AR	9.1GB SSA-SE HDD
-2	11J3570	AR	HDD Dummy Cover Use 1624764, (2) screws
-3	12K0474	AR	18.2GB SSA HDD
-4	21L3856	AR	HDD Jumper Assembly/Passthru
-5	12K0048	1	Label (Russia)
-6	31L7702	1	Label (Taiwan)
-7	12K0085	1	Label, Serial Number
-8	21L3843	1	Information Plate, US
-8	21L3844	1	Information Plate (sub for France)
-8	21L3845	1	Information Plate (sub for Ireland)
-8	12K0056	1	Information Plate (sub for Brazil)
-9	99J5101	AR	Alignment Fixture

Asm- Index	Part Number	Units	Description
12-1	31L7632	2	Hazardous Energy Label The 02G7521 Laser Label is part of this Label
-2	31L7643	AR	Label Set, Ref
-3	05N6560	AR	PCI Filler Use 92F1294 (1-4) screws
-4	05N6561	AR	ISA Filler Use 92F1294 (1-4) screws
-5	REF	1	Parallel Channel Card Use 1621180 (2) screws
-6	REF	1	SBC Card Use 92F1294 (4) screws
-7	11J4570	2	Label
-8	05N6147	1	I/O Cage Assembly
-9	31L7999	1	I/O Cage Dummy Cover, used in DASD Expansion Frame only

Assembly 13: Power Assemblies

Assembly view, rear and side

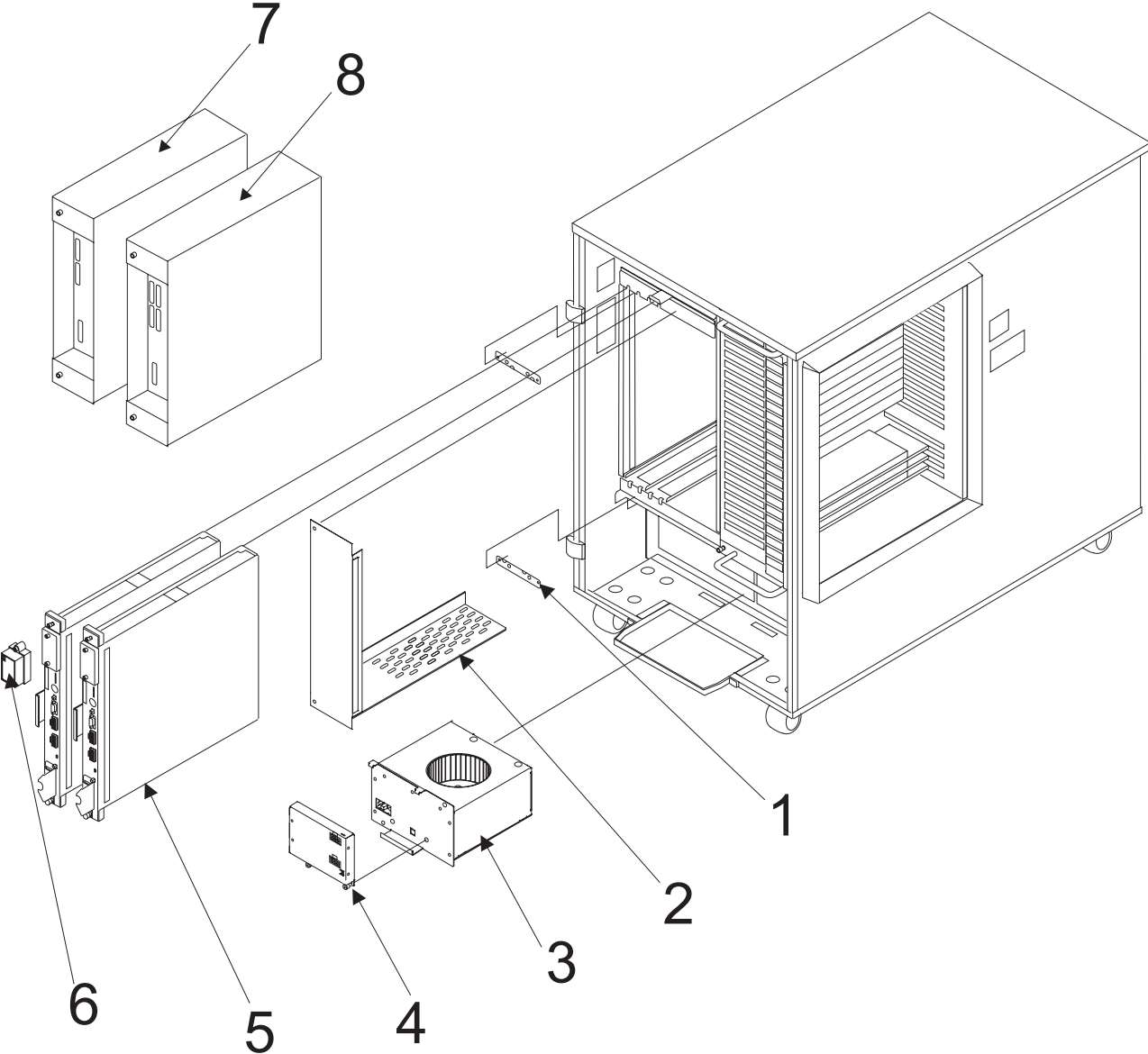

Asm- Index	Part Number	Units	Description
13-1	31L7962	2	Keying Plate Use 21F9002, (4) screws
-2	31L7637	1	PMI Airflow Bracket, used in DASD Expansion Frame only Use 1624764, (2) screws
-3	31L7030	2	MSA (Blower)
-4	31L7627	2	MDA (Motor Drive Assembly)
-5	12K0904	2	OCA (Offline Converter Assembly)
-6	11J4181	2	CBU(Crypto Battery Unit)
-7	REF	1	FIBB, used in I/O Expansion Frame only
-8	REF	1	PMI, used in Processor Frame only

Assembly 14: Cables

Asm- Index	Part Number	Units	Description
14-1	00G2380	AR	Ethernet Wrap Plug
-2	02K4243	AR	Speaker
-3	05N5290	AR	Cable Assembly, Ethernet Wakeup
-4	05N5291	AR	Cable Assembly, Token Ring Wakeup
-5	05N5371	AR	Cable Assembly, RS-422 Wrap
-6	08J5792	AR	Token Ring Wrap Plug
-7	11J5863	AR	Cable Assembly, STI .8 meter
-8	12K0278	AR	Cable Assembly, UPIC OCA1-P3 to AMD1-P2
-9	12K0279	AR	Cable Assembly, UPIC OCA2-P3 to AMD2-P2
-10	12K0280	AR	Cable Assembly, OCA to IBF
-11	12K0406	AR	Cable Assembly, Y Out Bus/Tag, Parallel Channel
-12	21L2716	AR	Cable Assembly, STI 3.3 meter
-13	31L7061	AR	Line Cord, US/Canada 110V, 6 ft.
-14	31L7062	AR	Line Cord, US/Canada 110V, 14 ft.
-15	31L7064	AR	Line Cord, US/Canada 220V, 6 ft.
-16	31L7065	AR	Line Cord, US/Canada 220V, 14 ft.
-17	31L7067	AR	Line Cord, US/Canada 110V, 6 ft., Twist-Lock
-18	31L7068	AR	Line Cord, US/Canada 110V, 14 ft., Twist-Lock
-19	31L7070	AR	Line Cord, US/Canada 220V, 6 ft., Twist-Lock
-20	31L7071	AR	Line Cord, US/Canada 220V, 14 ft., Twist-Lock
-21	31L7072	AR	Line Cord, China 220V, 14 ft.
-22	31L7073	AR	Line Cord, Europe 220V, 14 ft.
-23	31L7074	AR	Line Cord, Denmark 220V, 14 ft.
-24	31L7075	AR	Line Cord, Austrailia 220V, 14 ft.
-25	31L7076	AR	Line Cord, South Africa 220V, 14 ft.
-26	31L7077	AR	Line Cord, United Kingdom 220V, 14 ft.
-27	31L7078	AR	Line Cord, Japan 110V, 14 ft.
-28	31L7079	AR	Line Cord, Switzerland/US/Canada 110V, 14 ft.
-29	31L7080	AR	Line Cord, Italy 220V, 14 ft.
-30	31L7081	AR	Line Cord, Israel 220V, 14 ft.
-31	31L7662	AR	Cable Assembly, SBC/BIDI (Floppy)
-32	31L7663	AR	Cable Assembly, SBC/BIDI (SCSI)
-33	31L7671	AR	Cable Assembly, Parallel Channel Adapter
-34	31L7672	AR	Cable Assembly, SCSI Terminator
-35	31L7714	AR	Cable Assembly, SCSI Wrap Block
-36	31L7720	AR	Cable Assembly, USI
-37	31L7963	AR	Cable Assembly, OCA1-P4/OCA2-P4 to RS-422 (Processor Frame)
-38	31L7964	AR	Cable Assembly, OCA1-P4/OCA2-P4 to RS-422 (Expansion Frame)
-39	31L7985	AR	Cable Assembly, SSA .2 meter
-40	31L7986	AR	Cable Assembly, SSA 1.4 meter
-41	12K0874	AR	Cable Assembly, SSA 5 meter Was 31L7987
-42	5547283	AR	Diag Wrap Block
-43	6165899	AR	Token Ring Wrap Plug

Part Number Index

Part Number	Asm- Index Page	Part Number	Asm- Index Page	Part Number	Asm- Index Page	Part Number	Asm- Index Page
REF	12-5 27	12K0904	13-5 29	31L7072	14-21 31	31L7972	8-4 19
	12-6 27	13F9979	8-5 19	31L7073	14-22 31	31L7974	8-4 19
	13-7 29	14F0051	8-5 19	31L7074	14-23 31	31L7976	8-4 19
	13-8 29	14F0069	8-5 19	31L7075	14-24 31	31L7985	14-39 31
00G2380	14-1 31	1622419	1-9 5	31L7076	14-25 31	31L7986	14-40 31
02K4243	14-2 31	19F0740	7-5 17	31L7077	14-26 31	31L7999	12-9 27
05N5290	14-3 31	21L2716	14-12 31	31L7078	14-27 31	31L8002	10-6 23
05N5291	14-4 31	21L3345	2-1 7	31L7079	14-28 31	38F3968	8-5 19
05N5370	10-1 23	21L3352	3-1 9	31L7080	14-29 31	42G4996	8-3 19
05N5371	14-5 31	21L3354	4-2 11	31L7081	14-30 31	42H1295	8-7 19
05N6147	12-8 27	21L3366	1-2 5	31L7094	1-3 5	44H2792	9-7 21
05N6560	12-3 27	21L3369	9-5 21	31L7098	2-4 7	45L3587	7-4 17
05N6561	12-4 27	21L3372	6-13 15	31L7414	6-12 15	45L3588	6-3 15
05N6839	10-10 23	21L3374	6-8 15	31L7415	6-11 15	45L3589	6-6 15
05N6849	1-6 5	21L3510	5-3 13	31L7416	6-10 15	45L3592	6-4 15
07H0665	8-7 19	21L3515	10-8 23	31L7417	6-9 15	45L3593	6-7 15
07H0669	8-7 19	21L3787	4-4 11	31L7420	2-2 7	45L3598	8-1 19
07H0671	8-7 19	21L3788	4-5 11	31L7430	3-7 9	45L3599	8-2 19
07H0675	8-7 19	21L3789	4-3 11	31L7453	3-3 9	45L3600	8-9 19
07H0678	8-7 19	21L3791	3-4 9	31L7463	9-4 21	46G3536	1-8 5
07H0679	8-7 19	21L3792	3-8 9	31L7625	10-7 23	47H0216	10-2 23
07H0680	8-7 19	21L3802	6-5 15	31L7627	13-4 29	5547283	14-42 31
07H0681	8-7 19	21L3804	5-1 13	31L7632	9-1 21	60H1108	9-2 21
07H0687	8-7 19	21L3816	10-3 23		12-1 27	60H9963	8-6 19
07H0688	8-7 19	21L3828	7-2 17	31L7633	3-2 9	60H9965	8-6 19
07H0690	8-7 19	21L3830	7-3 17	31L7634	3-10 9	60H9967	8-6 19
07H0696	8-7 19	21L3831	1-10 5	31L7635	3-6 9	60H9969	8-6 19
07H0697	8-7 19	21L3832	1-5 5	31L7636	1-4 5	6165899	14-43 31
07H0698	8-7 19	21L3833	1-1 5	31L7637	13-2 29	6952301	8-5 19
07H0701	8-7 19	21L3837	4-1 11	31L7638	9-3 21	84X5038	3-5 9
08J5792	14-6 31	21L3840	7-1 17	31L7640	9-6 21		3-9 9
11J3570	11-2 25	21L3843	11-8 25	31L7643	10-5 23		3-12 9
11J4181	13-6 29	21L3844	11-8 25		12-2 27	99J5101	11-9 25
11J4570	12-7 27	21L3845	11-8 25	31L7644	1-7 5		
11J5863	14-7 31	21L3853	6-1 15	31L7648	7-6 17		
11P0586	10-9 23	21L3856	11-4 25	31L7662	14-31 31		
12K0048	11-5 25	31L7024	6-2 15	31L7663	14-32 31		
12K0056	11-8 25	31L7030	13-3 29	31L7671	14-33 31		
12K0085	11-7 25	31L7034	5-2 13	31L7672	14-34 31		
12K0277	7-7 17	31L7061	14-13 31	31L7690	8-8 19		
12K0278	14-8 31	31L7062	8-5 19	31L7694	2-3 7		
12K0279	14-9 31		14-14 31	31L7695	3-11 9		
12K0280	14-10 31	31L7064	14-15 31	31L7702	11-6 25		
12K0294	10-4 23	31L7065	14-16 31	31L7714	14-35 31		
12K0406	14-11 31	31L7067	14-17 31	31L7720	14-36 31		
12K0473	11-1 25	31L7068	14-18 31	31L7962	13-1 29		
12K0474	11-3 25	31L7070	14-19 31	31L7963	14-37 31		
12K0874	14-41 31	31L7071	14-20 31	31L7964	14-38 31		

Appendix A. Warranty

Statement of Limited Warranty

The warranties provided by IBM in this Statement of Limited Warranty apply only to Machines you originally purchase for your use, and not for resale, from IBM or an IBM authorized reseller. The term "Machine" means an IBM machine, its features, conversions, upgrades, elements, or accessories, or any combination of them. Machines are subject to these terms only if purchased in the United States or Puerto Rico, or Canada, and located in the country of purchase. If you have any questions, contact IBM or your reseller.

Machine: S/390 Multiprise 3000 Enterprise Server

Warranty Period*: One Year

**Elements and accessories are warranted for three months. Contact your place of purchase for warranty service information.*

Production Status: Each Machine is manufactured from new parts, or new and serviceable used parts (which perform like new parts). In some cases, the Machine may not be new and may have been previously installed. Regardless of the Machine's production status, IBM's warranty terms apply.

The IBM Warranty: IBM warrants that each Machine 1) is free from defects in materials and workmanship and 2) conforms to IBM's Official Published Specifications. IBM calculates the expiration of the warranty period from the Machine's Date of Installation. The date on your receipt is the Date of Installation, unless IBM or your reseller informs you otherwise.

During the warranty period, IBM or your reseller will provide warranty service under the type of service designated for the Machine and will manage and install engineering changes that apply to the Machine. IBM or your reseller will specify the type of service.

For a feature, conversion, or upgrade, IBM or your reseller may require that the Machine on which it is installed be 1) the designated, serial-numbered Machine and 2) at an engineering-change level compatible with the feature, conversion, or upgrade. Some of these transactions (called "Net-Priced" transactions) may include additional parts and associated replacement parts that are provided on an exchange basis. All removed parts become the property of IBM and must be returned to IBM.

Replacement parts assume the remaining warranty of the parts they replace.

If a Machine does not function as warranted during the warranty period, IBM or your reseller will repair or replace it (with a Machine that is at least functionally equivalent) without charge. If IBM or your reseller is unable to do so, you may return it to your place of purchase and your money will be refunded.

If you transfer a Machine to another user, warranty service is available to that user for the remainder of the warranty period. You should give your proof of purchase and this Statement to that user.

Warranty Service: To obtain warranty service for the Machine, you should contact your reseller or call IBM. In the United States, call IBM at **1-800-IBM-SERV (426-7378)**. In Canada, call IBM at **1-800-465-6666**. You may be required to present proof of purchase.

Depending on the Machine, the service may be 1) a “Repair” service at your location (called “On-site”) or at one of IBM's or a reseller's service locations (called “Carry-in”) or 2) an “Exchange” service, either On-site or Carry-in.

When a type of service involves the exchange of a Machine or part, the item IBM or your reseller replaces becomes its property and the replacement becomes yours. The replacement may not be new, but will be in good working order and at least functionally equivalent to the item replaced.

It is your responsibility to:

1. obtain authorization from the owner (for example, your lessor) to have IBM or your reseller service a Machine that you do not own;
2. where applicable, before service is provided —
 - a. follow the problem determination, problem analysis, and service request procedures that IBM or your reseller provide,
 - b. secure all programs, data, and funds contained in a Machine,
 - c. inform IBM or your reseller of changes in a Machine's location, and
 - d. for a Machine with exchange service, remove all features, parts, options, alterations, and attachments not under warranty service. Also, the Machine must be free of any legal obligations or restrictions that prevent its exchange; and
3. be responsible for loss of, or damage to, a Machine in transit when you are responsible for the transportation charges.

Extent of Warranty: IBM does not warrant uninterrupted or error-free operation of a Machine.

Misuse, accident, modification, unsuitable physical or operating environment, improper maintenance by you, or failure caused by a product for which IBM is not responsible may void the warranties.

THESE WARRANTIES REPLACE ALL OTHER WARRANTIES, EXPRESS OR IMPLIED, INCLUDING, BUT NOT LIMITED TO, THE IMPLIED WARRANTIES OF MERCHANTABILITY AND FITNESS FOR A PARTICULAR PURPOSE. HOWEVER, SOME LAWS DO NOT ALLOW THE EXCLUSION OF IMPLIED WARRANTIES. IF THESE LAWS APPLY, THEN ALL EXPRESS AND IMPLIED WARRANTIES ARE LIMITED IN DURATION TO THE WARRANTY PERIOD. NO WARRANTIES APPLY AFTER THAT PERIOD.

In Canada, warranties include both warranties and conditions.

Some jurisdictions do not allow limitations on how long an implied warranty lasts, so the above limitation may not apply to you.

Limitation of Liability: Circumstances may arise where, because of a default on IBM's part (including fundamental breach) or other liability (including negligence and misrepresentation), you are entitled to recover damages from IBM. In each such instance, regardless of the basis on which you are entitled to claim damages, IBM is liable only for:

1. bodily injury (including death), and damage to real property and tangible personal property; and
2. the amount of any other actual loss or damage, up to the greater of \$100,000 or the charge for the Machine that is the subject of the claim.

Under no circumstances is IBM liable for any of the following:

1. third-party claims against you for losses or damages (other than those under the first item listed above);
2. loss of, or damage to, your records or data; or
3. economic consequential damages (including lost profits or savings) or incidental damages, even if IBM is informed of their possibility.

Some jurisdictions do not allow the exclusion or limitation of incidental or consequential damages, so the above limitation or exclusion may not apply to you.

This warranty gives you specific legal rights and you may also have other rights which vary from jurisdiction to jurisdiction.

Appendix B. Notices

This information was developed for products and services offered in the U.S.A..

IBM may not offer the products, services, or features discussed in this document in other countries. Consult your local IBM representative for information on the products and services currently available in your area. Any reference to an IBM product, program, or service is not intended to state or imply that only that IBM product, program, or service may be used. Any functionally equivalent product, program, or service that does not infringe any IBM intellectual property right may be used instead. However, it is the user's responsibility to evaluate and verify the operation of any non-IBM product, program, or service.

IBM may have patents or pending patent applications covering subject matter described in this document. The furnishing of this document does not give you any license to these patents. You can send license inquiries, in writing, to:

IBM Director of Licensing
IBM Corporation
North Castle Drive
Armonk, NY 10504-1785
USA

The following paragraph does not apply to the United Kingdom or any other country where such provisions are inconsistent with local law:

INTERNATIONAL BUSINESS MACHINES CORPORATION PROVIDES THIS PUBLICATION "AS IS" WITHOUT WARRANTY OF ANY KIND, EITHER EXPRESS OR IMPLIED, INCLUDING, BUT NOT LIMITED TO, THE IMPLIED WARRANTIES OF NON-INFRINGEMENT, MERCHANTABILITY OR FITNESS FOR A PARTICULAR PURPOSE. Some states do not allow disclaimer of express or implied warranties in certain transactions, therefore, this statement does not apply to you.

This information could include technical inaccuracies or typographical errors. Changes are periodically made to the information herein; these changes will be incorporated in new editions of the publications. IBM may make improvements and/or changes in the product(s) and/or the program(s) described in this publication at any time without notice.

Any references in this information to non-IBM Web sites are provided for convenience only and do not in any manner serve as endorsement of those Web sites. The materials at those Web sites are not part of the materials for this IBM product and use of those Web sites is at your own risk.

IBM may use or distribute any of the information you supply in any way it believes appropriate without incurring any obligation to you.

Trademarks

The following terms are trademarks of International Business Machines Corporation in the United States, or other countries, or both:

IBM

Multiprise

S/390

Electronic Emission Notices

The following statement applies to this IBM product. The statement for other IBM products intended for use with this product will appear in their accompanying manuals.

Federal Communications Commission (FCC) Statement

Note: This equipment has been tested and found to comply with the limits for a Class A digital device, pursuant to Part 15 of the FCC Rules. These limits are designed to provide reasonable protection against harmful interference when the equipment is operated in a commercial environment. This equipment generates, uses, and can radiate radio frequency energy and, if not installed and used in accordance with the instructions contained in the installation manual, may cause harmful interference to radio communications. Operation of this equipment in a residential area is likely to cause harmful interference, in which case the user will be required to correct the interference at his own expense.

Properly shielded and grounded cables and connectors must be used in order to meet FCC emission limits. IBM is not responsible for any radio or television interference caused by using other than recommended cables and connectors, by installation or use of this equipment other than as specified in the installation manual, or by any other unauthorized changes or modifications to this equipment. Unauthorized changes or modifications could void the user's authority to operate the equipment.

This device complies with Part 15 of the FCC Rules. Operation is subject to the following two conditions: (1) this device may not cause harmful interference, and (2) this device must accept any interference received, including interference that may cause undesired operation.

Canadian Department of Communications Compliance Statement

This equipment does not exceed Class A limits per radio noise emissions for digital apparatus, set out in the Radio Interference Regulation of the Canadian Department of Communications. Operation in a residential area may cause unacceptable interference to radio and TV reception requiring the owner or operator to take whatever steps are necessary to correct the interference.

Avis de conformité aux normes du ministère des Communications du Canada

Cet équipement ne dépasse pas les limites de Classe A d'émission de bruits radioélectriques pour les appareils numériques, telles que prescrites par le Règlement sur le brouillage radioélectrique établi par le ministère des Communications du Canada. L'exploitation faite en milieu résidentiel peut entraîner le brouillage des réceptions radio et télé, ce qui obligerait le propriétaire ou l'opérateur à prendre les dispositions nécessaires pour en éliminer les causes.

Readers' Comments — We'd Like to Hear from You

S/390

Parts Catalog

Publication No. S123-7471-01

Is there anything you especially like or dislike about this book? Feel free to comment on specific errors or omissions, accuracy, organization, or completeness of this book.

IBM may use or distribute whatever information you supply in any way it believes appropriate without incurring any obligation to you, and all such information will be considered nonconfidential.

No postage stamp necessary if mailed in the U.S.A. (Elsewhere, an IBM office or representative will be happy to forward your comments or you may mail directly to the address in the Edition Notice on the back of the front cover or title page.)

Note

Do not use this form to report system problems or to request copies of publications. Instead, contact your IBM representative or the IBM branch office serving you.

Would you like a reply? YES NO

Name

Address

Company or Organization

Phone No.



Cut or Fold
Along Line

Fold and Tape

Please do not staple

Fold and Tape

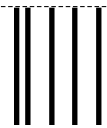

NO POSTAGE
NECESSARY
IF MAILED IN THE
UNITED STATES

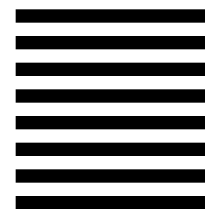

BUSINESS REPLY MAIL

FIRST-CLASS MAIL PERMIT NO. 40 ARMONK, NEW YORK

POSTAGE WILL BE PAID BY ADDRESSEE

International Business Machines Corporation
Information Development
Department C9MG
1701 North Street
ENDICOTT NY 13760-9987



Fold and Tape

Please do not staple

Fold and Tape

Cut or Fold
Along Line



Printed in the United States of America
on recycled paper containing 10%
recovered post-consumer fiber.

S123-7471-01

